

# MOTORIZED DEWAR CART



# MOTORIZED DEWAR CART



SPECIFICATIONS	
Capacity	1100 lbs.
Capacity, 3:1 Ramp	750 lbs.
Weight	340 lbs.
Speed (FWD/REV)	3.8 / 2.5 mph
System Voltage	36 Volts DC
Payload	20", 26" Dewars Up to 4 High Pressure Cylinders
Range (Continuous/ Intermittent)	3 hrs. / 8+ hrs.
Recharge Time	3-6 hrs.

**MODEL SHOWN**  
MDC90B1

## DIMENSIONS

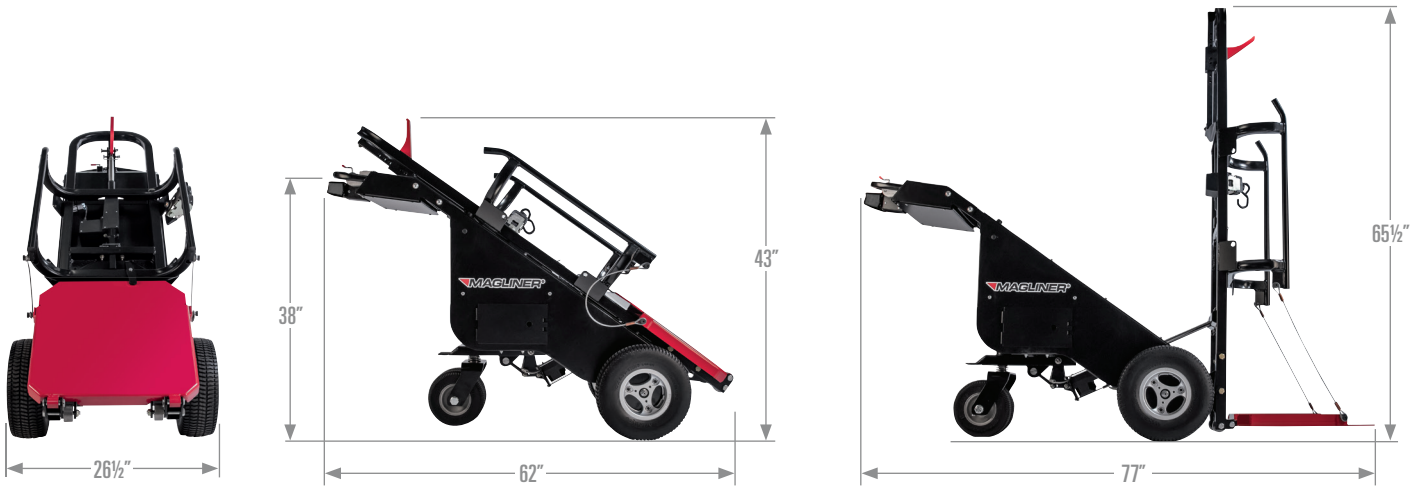

## DRIVE WHEEL OPTIONS



P/N	D"	WT.(LBS.)
10993	13	10

Foam filled tire is maintenance free.

P/N	D"	WT.(LBS.)
10992	13	8

Tube-type pneumatic tire.

## ACCESSORIES

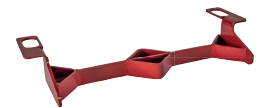
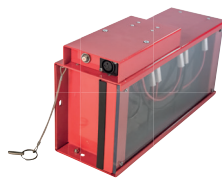

P/N	WT.(LBS.)
460097	35.8

Battery box assembly complete with three 12V batteries (36V total).

P/N	L'	W"	WT.(LBS.)
450024	10	2	2.8

Retractable ratchet strap has 3300 lbs. maximum load and 1100 lbs. working load capacity.

P/N	WT.(LBS.)
460180	6.8

HP cylinder retention bar secures up to 4 cylinders to prevent shifting.

# MOTORIZED DEWAR CART

## SAFETY FEATURES



Electric tilt-up rack prevents the need for operator to lift cart up to load or unload dewars.

- Park brake automatically engages when throttle position is zero; locks machine in place.
- Park brake can be manually released; locks out propulsion.
- Push-too-fast feature insures no runaway even when brake is manually released.

Smart gauge provides battery charge status as well as trouble shooting codes.

High-Low speed switch.

Propulsion system provides regenerative braking that slows down load when operator reduces throttle input – even on ramps.

Auto return to zero from forward or reverse will slow down and stop the unit if contact with throttle control is lost.

Permissive interlock feature prevents accidental activation of propulsion while operating the halo hook or tilting up the rack.

Anti-pinning belly button prevents operator being pinned while operating in reverse.



# MOTORIZED DEWAR CART

## PRODUCTIVITY GAINS

The Magliner Dewar cart moves cylindrical products at speeds up to 3.8 mph, and 2.5 mph in reverse. Average load time is 40 seconds, and unload time 45 seconds.



round and square base

### 20" AND 26" DIAMETER DEWAR

Halo hook is primary retention, retractable strap is redundant.



### HIGH PRESSURE CYLINDERS

Retractable strap is primary retention, optional cylinder bar offers stabilization.

## VERSATILITY

4" adjustable extension for a total of 12" of vertical hook travel. Enough to pick the tallest 20" Dewars and shortest 26" Dewars.

Two halo hooks are standard. One for 20" and one for 26" Dewars. Only takes seconds to switch.

No user certification required.



Weather-Proof Storage/Tool Box.

**MAGLINER**<sup>®</sup>

[www.aelift.com](http://www.aelift.com)

Allstate Equipment Company Inc  
1201 McCloud Rd | Chesapeake, VA 23320 | USA  
757-545-1900  
sales@aelift.com